

TEFLÓN® protects all the internal cables

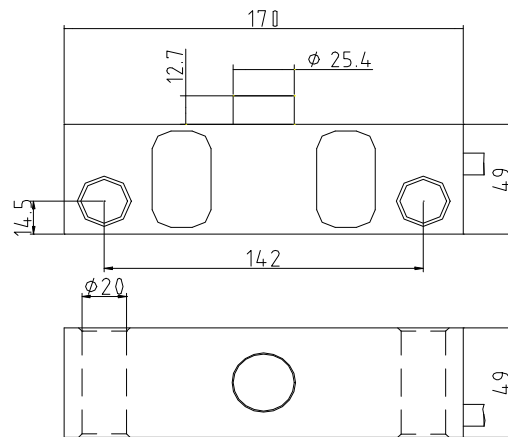

Dimensions in mm

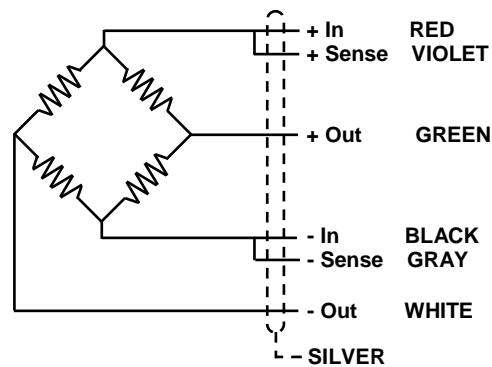

**APPLICATION:**

Weighbridges and silos

**CAPACITY RANGE:**

10t - 15, 120t - 20t - 25t - 30t

**MATERIAL:**

Stainless Steel

**ENVIRONMENTAL PROTECTION:**

IP68

**APPROVALS:**

CE 3000 & 4000 Div - E.03.02.C09

According to OIML - R60

**CHARACTERISTICS**

Construction using stainless steel. The laser soldered closing protects from the typical environment in food and chemical industry. Mounting compatibility.

**APPLICATIONS**

The CBCI model belongs to the double shear beam type. It has excellent linearity and supports the intensive traffic of trucks.

It's protected from the environmental conditions existing in industries, where tasks and cleaning demand.

**OPTIONS**

Length of the cable is optional.

Hostile environmental cable.

ATEX option

EC-Type examination certificate

CEC 11 ATEX 040 X according directive 94/9/EC

**Ex** II 1G EExia IIC T6 (Ta2-0÷+40°C)  
TX (Ta-20÷+65°C)

**Ex** II 1D tD A20 TX°C (Ta-20÷+40°C)  
TX°C (Ta-20÷+65°C)

For more information look up the EC-type examination certificate, and documentation.

Consult for special requirements.

## GENERAL TECHNICAL CHARACTERISTICS FOR $g = 9,8031 \text{ m/s}^2$

OIML Class	C3 - C4	UNITS
Divisions $n_{LC}$	3000 - 4000	
Minimum Dead load $E_{min}$	0	kg
$Z = E_{max} / 2DR$	3000 - 4000	
$Y = E_{max} / V_{min}$	10000	
Rated Capacity $E_{max}$	10000 - 15120 - 20000 - 25000 30000	kg
Rated Sensitivity C	$2 \pm 0,1 \%$	mV/V
Rated Input Voltage	10	V dc
Input Voltage Range	5...15	V ac/dc
Input Resistance $R_{LC}$	$700 \pm 10$	$\Omega$
Output Resistance	$700 \pm 10$	$\Omega$
Zero Balance	$\pm 2$	% Emax
Insulation Resistance at 50 V DC	> 5000	M $\Omega$
Service Overload	> 150	% Emax
Overload Limit	> 300	% Emax
Temperature Range : Compensated	- 10 ... 40	$^{\circ}\text{C}$
: Operating	- 30 ... 85	$^{\circ}\text{C}$
: Storage	- 30 ... 90	$^{\circ}\text{C}$
Max. Nonlinearity	0,015	% Emax
Max. Hysteresis	0,015	% Emax
Max. No repeatability	0,01	% Emax
M Max. Creep in 4 hours	0,02	% Emax
Max. Zero Recovery Test in 1/2 hour	0,007	% Emax
Max Temperature effect : On Sensitivity	0,00097	% Emax / $^{\circ}\text{C}$
: On Zero	0,00116	% Emax / $^{\circ}\text{C}$
Weight	3320	g
Cable Length	15	m
Environmental Protection	IP68 - DIN 40050 (100h 1m)	



Ref: 491020



Ref: 491022  
Ref: 491023 (S. Steel)



Ref: AF257



Ref: 496009



Ref: 491025  
Ref: 491026 (S. Steel)